



**Robin Close, Bury St. Edmunds, IP28 7HJ**  
**Rent - £1,000 PCM      Deposit - £1,153**

This one bedroom apartment is situated on a popular residential estate close to the town centre. There is an open plan lounge/kitchen with a fitted bathroom and first floor bedroom. An ideal home to suit a single tenant or couples alike. Off road parking is offered to ensure security. Call now to view!

- DOUBLE BEDROOM
- MODERN KITCHEN/DINER
- GARDEN
- CLOSE TO TOWN CENTRE
- EPC RATING - D
- OPEN PLAN
- AIR-CONDITIONING
- EASY COMMUTE TO RAF BASES
- COUNCIL TAX BAND - A
- CALL SHIRES NOW TO VIEW!



Council Tax Band: A - EPC Rating: D 68

GROUND FLOOR  
16.7 sq.m. (180 sq.ft.) approx.

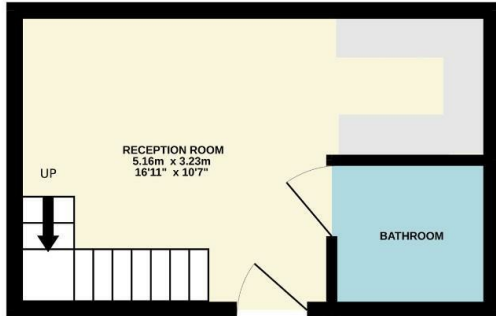

1ST FLOOR  
16.7 sq.m. (180 sq.ft.) approx.

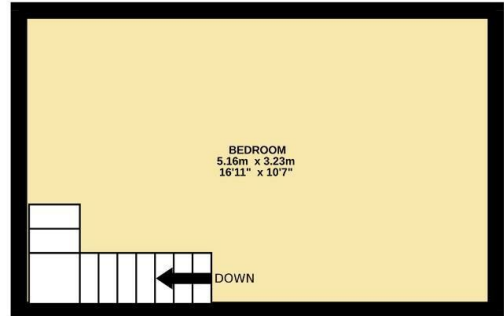

TOTAL FLOOR AREA: 33.4 sq.m. (359 sq.ft.) approx.

Whilst every attempt has been made to ensure the accuracy of the floorplan contained here, measurements of doors, windows, rooms and any other items are approximate and no responsibility is taken for any error, omission or mis-statement. This plan is for illustrative purposes only and should be used as such by any prospective purchaser. The services, systems and appliances shown have not been tested and no guarantee as to their operability or efficiency can be given.  
Made with Metropix ©2026

